

Helios 500

Intraoral Scanner

- Automatic & adaptive calibration, manual calibration is not necessary any more.
- One of the most accurate and fastest scanners on the market.
- - Small & light enough to operate it easily,
- Though it achieves a 16mm x 14mm high-definition field of view.



Faster

Scan a full arch in less than 30 seconds with HELIOS 500



Accurate

As one of the most accurate scanners in the market, HELIOS 500 has reached the state-of-the-art accuracy level- the average deviation of an in-vivo full arch scan is around 20µm.



Lighter

Only 185gm, one of the most lightweight scanners in the market, well-balanced, ergonomically designed and easy to carry.



AI Driven

AI technology filters the soft and moving tissues, offering users a smooth scanning experience and generating a natural-looking treatment outcomes.



KNOW
MORE

orikam | **Eighth**

Helios 500

Intraoral Scanner

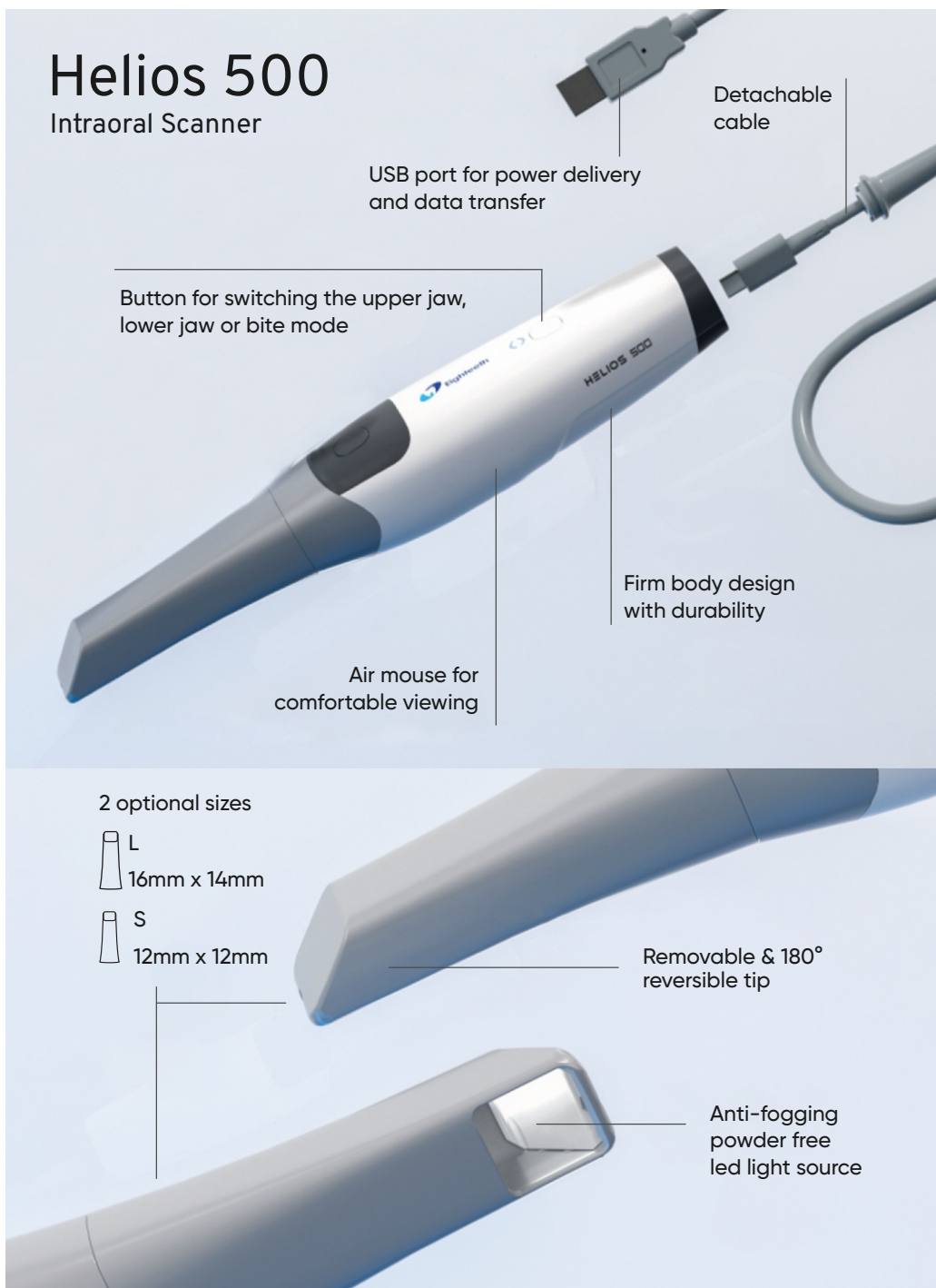

Plug & Scan with Helios 500!



Smart Reminder



Air mouse



Automatic software update



Timely after-sales service



Cloud Storage



Voice note



Online 3D viewer

Helios 500 Specification

Accuracy	Full-arch	20.0μm
	Scan area	16 x 14mm (L)
		12 x 12mm (S)
Hand-piece	Dimensions	217 x 54 x 24mm
	Weight	185gm
Tip	Tip size (Front part)	22 x 18mm (L)
		18.6 x 16.7mm (S)
Connectivity	Length	1.8m
	Type	USB 3.0
Calibration	Accuracy Calibration	Calibration-free
	Color Calibration	Calibration-free
Data	Output format	STL/PLY

Recommended System Requirements

Processor - Intel®Core™ i7 12th Generation,
base frequency 2.4 GHz (or better)

Memory - 16GB (or more) DDR4,
frequency 2666 MHz (or better)

Hard Drive - 256GB (or more) SSD

Graphics card - NVIDIA®GeForce®GTX 3050
(or better)

Display - 15.6" FHD (1920 x 1080) (or more)

Others - USB 3.0 port

Operating system - Windows 10 Pro